

Maida Vale Properties

SALES

ESTATE AGENTS

LETTINGS

VALUERS

431-433 Edgware Road, Little Venice, London W2 1TH

www.maidavaleproperties.co.uk 020 7258 3737 / 7724 6868 info@maidavaleproperties.co.uk

Northwick Terrace, St Johns Wood, NW8 **8JB**

**ONE DOUBLE BEDROOM | GROUND FLOOR | SPACIOUS LOUNGE | FULLY FITTED KITCHEN |
FULLY TILED BATHROOM | CONVENIENTLY LOCATED |**

Offered for sale is this bright spacious and delightful one double bedroom apartment situated on the ground floor of a small purpose built block on the borders of Maida Vale and St Johns Wood. The property comprises of a spacious lounge, nicely decorated one double bedroom, fully fitted kitchen and fully tiled bathroom. Conveniently located, close to all the shops, cafes and restaurants on the prestigious Clifton Road. The property is a short walk from both Warwick Avenue (Bakerloo Line) and St Johns Wood (Jubilee line) for transport links.



Purchase Price: £529,000





NORTHWICK TERRACE, NW8 8JB

Approx. Gross Internal Floor Area 490 sq ft. / 45.58 sq.m

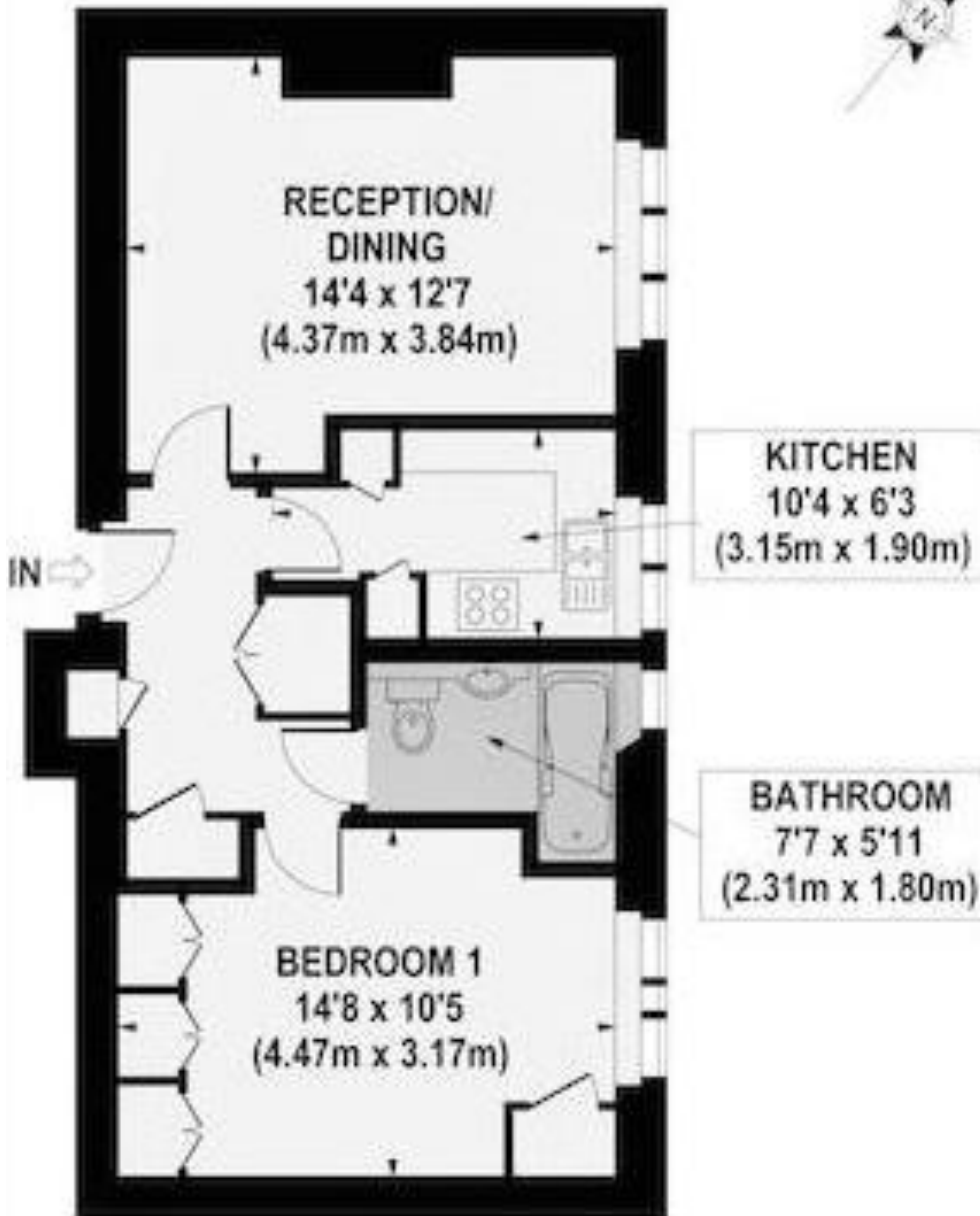

GROUND FLOOR

Terms

Lease: 38 years

Service Charge: £2,300 per Annum